

LOST MEDINA COUNTY TOWNS

Mallet Creek resident Walter Thomas collected over 50,000 Medina County letters. The oldest was from 1811. One envelope was marked 'delivered by hand and by steamboat'. One from 1823 was sent to 'near Cleves State of Ohio, Medina Ohio'. There were once 47 post offices in the county. Susan McKiernan November 2019
weymouthpreservation@gmail.com

ABBEYVILLE was at Abbeyville and Hamilton Rds. Post office 25 June 1833 to 4 May 1868, and again 31 January 1870 to 30 August 1902. "In the winter of 1831-32 Wesley Hulet built two mills on the Rocky River, near the present site of the village of Abbeyville, one for sawing lumber and the other for grinding grain." Frederick Amendt built a stone, timber and brush mill gristmill, dam and race in the summer of 1833, deserted by 1881.



ACME was at routes 3 and 97 near Seville. Post office 9 April 1886 to 30 November 1901.

BAGDAD at Granger and Nettleton Roads, was settled in 1816. Bagdad was an important milling point for many years. Moore & Stevens erected a saw-mill early in 1818. Mr. Badger built a mill on the Rocky River in 1823. It's said to have once had a store and church; Fenn Road (Medina Center) Cemetery was often called Bagdad cemetery. Doc Loomis said that, "There was a crading factory with a water wheel. Medina and Granger riders would go there and the fellow twho ran the mill would temporarily divert the race and take the travelers in through a door hidden behind the wheel. Once secures, he redirected the water and started the wheel up again".

BAKERS CORNERS

BEEBETOWN Rte 303 at Substation Rd. Post office 15 February 1889 to 30 August 1902.



1923 photo of Beebetown School built 1872



Beebetown church 1852-1906

BENNETTS CORNERS at Boston Road and W 130th Street. There is still a Methodist church and cemetery; had a post office 1863-1904, also a school.

BLAKE was at Tower and Blake Roads in Guilford Township, 5 miles NW of Wadsworth, 5 miles NE of Seville and 7 miles S of Medina. Blake was called **STEAMTOWN** in 1836.

BONETA at Boneta and Sharon-Copley Rds. There was a post office on the PA&W railroad 28 September 1892, closed 15 May 1905. In 1934 Boneta District school #11 and its land were sold to Ray Hollopeter, owner of the Boneta general store. He used the 60-year-old building to house his tractor agency. Fred Ruckel of Boneta bought the bell and cupola for \$1.05 for an ornament in his rock garden. Built in 1847 or 1848, it was replaced after a fire 25 years later, no classes held in it after 1922.

BOONES CORNERS

BRANTS CORNERS 1865, 1874 "above Hinckley Center"

BRIARWOOD BEACH NW of Lake and Chippewa Roads in Chippewa-on-the-Lake

BRUNSWICK HEIGHTS 1944.

BUCKS CORNERS is 1 mile west of West Richfield and 1½ miles north of Osborns Corners c 1915.

BURBANK bottom right of Harrisville Twp into Wayne County

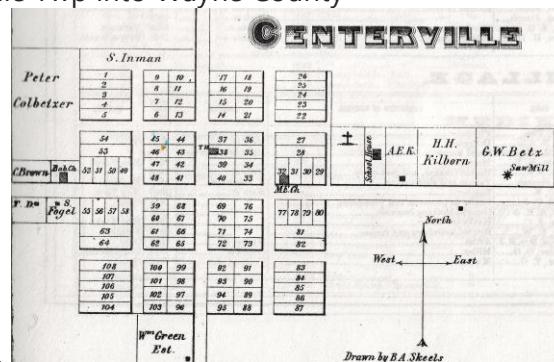

CENTERVILLE was Spencer in 1874.

CHASE BROOK CORNERS About where 71 crosses 18. There was a schoolhouse here 1902-1931.

CHATHAM Post office established as Chatham Centre Post Office 20 June 1837, name changed to Chatham Centre Post Office on 29 November 1893. Name changed to Chatham Post Office on 9 January 1895, discontinued on 30 November 1920.

CHERRY CORNERS where Congress Rd crosses Lafayette Road SW in Harrisville Township, near West Salem. Cherry Corners Evangelical Lutheran Church (still standing) built 1931 across the street.

CLARKS CORNERS north of Wadsworth at Reimer Road 1931. Had a Free Will Baptist meeting house.

CODDINGVILLE in Granger Township on Rte 18 at State Rd 1½ miles east of Renners Corners in 1927.

CRAWFORD CORNERS/CRAWFORD MILLS school was in Harrisville Twp at Lafayette & Congress Roads.

DICKEY TRACT bottom right corner Brunswick Township

ERHART Post Office March 13 1873 to July 31 1943.



Erhart in the 1890s.

FARLEY CORNERS Granger Township on the Bath side, there was a one-room schoolhouse there.

FENNS CORNERS 42 and Fenn Rd. Fenns Corners school was on the site of Fish & Chips later the rustic Inn, was interurban stop 76½. In 1907 "teachers at Fenn Corners and Medina Center are paid \$40 a month and sometimes have only 5-6 scholars —why not consolidate"?

FIVE POINTS

FRANKS CORNER west of Valley City. Charles Frank operated a large feed and grain business from part of his home at the SE corner of 303 and Substation Rds. Chas G Betz was blacksmith there many years.



FRIENDSVILLE west of Westfield Center. Greenwich Rd between Friendsville and Westfield Rds. Post office 7 February 1899 - 30 November 1901; there may have been an earlier post office in 1867.

GARDEN ISLE at rte 90 just west of Cemetery Rd had a branch post office that served the huge produce farms there. On Garden Isle Road in Harrisville Township.

GLORIA GLENS Eastlake at Ryan Roads in Chippewa-on-the-Lake

GOODMANS CORNER

GRANGER post office March 8 1816, discontinued Nov 30 1901.



Granger school 1911.



1909

GRANGERBURG on Granger Rd between Ridge/Beachler and Dunsha Roads.

GUILDFORD POST OFFICE later known as Seville.

HALES CORNER

HAMILTON CORNERS at Hamilton Rd & 42. Settled in 1816. There is a cemetery and was a school

HARRISONVILLE RESERVE post office 1829, later called Lodi.

HOMERVILLE at Greenwich and Spencer Roads

HOMER STATION north of Homerville on Spencer Road at the B&O tracks in 1921

JOHNSONS CORNERS is 1 mile N of Weymouth 1931.

JOHNSONS CORNERS is at Ryan and Lake Roads, ¼ mi east of Chippewa Lake Post Office 1931.

CHIPPEWA-on-the-LAKE established as Marr Post Office 13 February 1873, name changed to Chippewa Lake on 27 December 1875. **LAKE STATION**, at the railroad tracks just N of the village.

LIBERTY HILL ½ mile east of Remsen corners. Had a general store.

LEINSEDER CORNERS school on the east side of Marks Rd north of Center

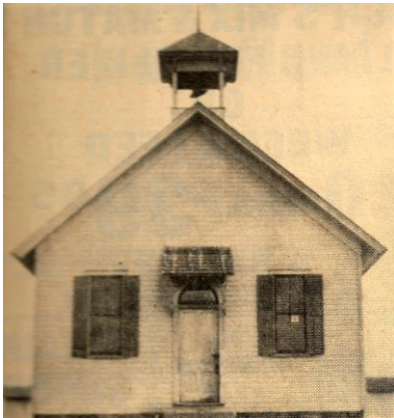

Leinseder School



Mamie Codding teacher of Leinseder School 1906

LELANDS CORNER (near Seville) Dan Yost is grocer 1902.

LeROY post office established 1825. Became Westfield Center in 1971.



LESTER at Elyria and Speith Roads in York Township.



MALLET CREEK at Rte 18 and 252/57 in York Township. Established as Mallett Creek Post Office on 20 July 1837, name changed to Mallettcreek Post Office on 1 December 1895. Name changed back to Mallett Creek Post Office on 1 December 1905, discontinued on 31 May 1926



Mallet Creek: Lester Dam Bridge c. 1910

HOLCOMB'S ACOUSTIC TELEPHONE!
THE ONLY
ACOUSTIC TELEPHONE
having a clear title to Patent, and embodying all latest improvements, including New Vocalizing Chamber, Metal Diaphragm, Etc. This Telephone excels all others in clearness and volume of tone; will work in all kinds of weather, and for lines **one mile** or less in length it is the **best Telephone in use.**
Hundreds of these instruments are in successful operation in all parts of the country. Sample set, \$3.50. Illustrated Circulars and Testimonials from those who have them in use, sent free.
J. R. HOLCOMB & Co., Mallet Creek, Ohio.

To Apply **TELEGRAPH OPERATOR,**
OR EXPRESS AGENT,
47 West Fairview
Cumberland Co., Pa.

MAPLE TREE CORNERS was in Hinckley Twp

MARYSVILLE or **HARDSCRABBLE** at Grafton and Columbia Rds in Liverpool Township. "During the summer of 1811, a large clearing had been made on the Warner farm. Indians were encamped near the little settlement, and one day they informed Justus Warner that they knew of a large, very salty spring on his farm and offered to reveal its location for a few pieces of coin. The amount was paid, the whereabouts of the spring was disclosed, and the water was found so extremely salty as to make it apparent that salt could be easily manufactured from it" He set up a salt operation – had 50 kettles boiling at one time – sold for \$20 a barrel. The spring was located on the west bank of Rocky River, a short distance above Marysville/Hardscrabble.



Herman Schafer dry goods. He died in Hardscrabble 1919

McCREADYS CORNERS

McCURDY TRACT center bottom area of Brunswick Township in 1921

MEDINA COURTHOUSE later called Medina. Post office established April 24, 1819. *Note: there is one early map that refers to Medina as Mecca, repeated in many later sources, and it's said that the name was changed from the*

birthplace of Muhammad to his place of death because there was already a Mecca in Trumbull County. But exhaustive research does not prove this. Original records dating back to 1812 call it Medina.

MEDINA CENTER where Medina Township Hall is today. There was a school in 1907: "Teachers at Fenn Corners and Medina Center are paid \$40 a month and sometimes have only 5-6 scholars —why not consolidate"?

MEDINA STATION was where the depot was on W Liberty in Rootville in 1881. There was a branch post office, West End Post Office, until about 1927 to serve the AI Root Company.

MERRIC TRACT bottom west corner of Lafayette Township

MILTON STATION became Ellio, then Arkona, then Rittman in 1881.

MINERS CORNER/MINERS CROSSING In 1909 stop 74½ of the electric line at LA Miner's 110-acre farm 4 miles North of Medina, ½ mile east of Abbeyville, west of Hamilton's Corners. There was a 10-room brick house and bank barn. In 1921 the CS&C car struck and killed Glenn V Kingsbury and Wm C Frambach at Miner's Crossing. The Frambach estate got \$500.

MONGS CORNER was North of Seville at rtes 3 and 224. In 1940 traffic light at Mongs Corners was taken down as county couldn't bear the expense. Myers Gas filling station and Sanborn Hatchery were there in 1944.

MONTROSE Summit County, better known as Ellis Corners 1902.

MOUNT PLEASANT Still has a United Methodist Church and Town Line Cemetery established 1824



NORTHROPVILLE where Granger Rd meets Nettleton. Also called Pennyville because when dances were held they threw coins on the floor for the fiddlers.



The 1848 Northropville School SW corner of Granger and Nettleton Rds.

OSBORN CORNERS Medina Line Rd at Ledge Road. In 1938 May 31 p. 1 Picture of 1882 school bell and belfry from Osborn's Corners; the bell was taken to Camp Crag.

PAWNEE at Pawnee and New London Eastern Roads in Spencer Township. Pawnee was originally called Esselburn's Corners, after Louis Esselburn who started a general store there in 1872. L Esselburn grocery between Harrisville and Homer 1870. A post office called Pawnee was established Jan 21 1879, and remained in operation until Aug 30 1887. Old saw mill at Pawnee destroyed by fire 1948.

PAXTON On South Medina Line Rd between Sharon-Copley and Minor Roads.

PEKIN In Hinckley Township on Ledge between 94 and the Summit County line. 1937 New State highway: county roads 9 and 135 south of Hinckley Center leading off 3 down through Pekin and beyond to where it joins 94.

PIERCES CORNER lot 34 cooper shop 1/2 mile west of Granger

PIGEON CREEK just west of South Hametown Rd and Ridgewood Rd

PIKE STATION 1881 now Creston.

PLINY 1901 *Gazette*: "New Medina County post office called Pliny, James A Lewis is PM but we don't know where it is". It was at RR tracks west of the Zion church near Abbeyville.

POE was at Wadsworth and Poe Roads in Montville Township. Post office 12 March 1860 to 30 November 1909. A Methodist church here; an Episcopal Church joined with St Paul's Medina in 1836.



REMSEN The area southeast of Remsen and Stony hill Roads 1921.

REMSEN CORNERS at 94 and Remsen Road. There is still a Methodist church; was a school, general store, and blacksmith shop. Post office 14 March 1855 - 30 November 1901.



FRONT PORCH personell of the "good old days" at the Remsen Corner's Store are shown in this picture taken about the turn of the century. A recent story in The Gazette Leader Post by V. E. "Doc" Salisbury, recalling some of the fun of those days prompted Mrs. Ruth Hall of 422 E. 5th St. to submit this photograph. It shows (l to right) A. F. Haigh, the store owner many years; Albert Anderson, and John De can, in a familiar pose of those days.



RENNERS CORNER was at rtes 94 and 18, 4 mi East of Medina, 2.5 mi North of Sharon Center. Lewis H Renner age 94 died at Renners Corners in 1944, stock dealer 50 years.

RISLEY "A hamlet (a village without a church) with a post office and railroad station at the south edge of Litchfield township". 9 miles west of Medina on Smith Rd. Romanzo Broughton Postmaster at Risley Jan 25 1897 to Jan 17 1900. In 1916 the school at Risley closed; it served both sides of Smith Road. Risley still there 1928.

RIVERS CORNERS at Congress and Rivers Corners roads in Spencer Twp: The first saw mill was built on the Black River at Rivers Corners by Calvin Spencer about 1833. The dam was built about six months after the mill, and Mr. Spencer began to get out lumber to build a grist mill soon after.

RIVER STYX where Styx Hill, Wadsworth and River Styx Roads meet. Also known as Fisherman's Corners.

RUSSELL STATION

SANFORD TRACT east line of Brunswick Township

SHELDONS CORNERS east of Remsen Corners. Myron Sheldon at one time operated a saw and gristmill west of the corner.

SHERMANS CORNERS 3 miles E of Brunswick & 2 miles west of Hinckley on 303. At W 130th and Rabbit Patch Rd where the UB Church is and the abolitionist Hiram Miller's marker and former house.

SMITH ROAD in Sharon Township had a post office in 1850, still there in 1880.

SPENCER MILLS

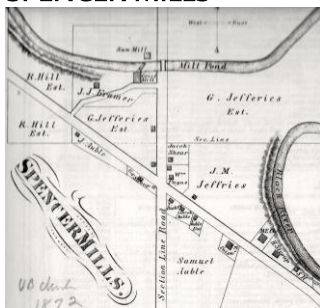

STEAMTOWN see Blake

STONEY HILL rte 18 at Hametown Rd. The school at 49 N Hametown Rd closed 1921.



STONY RIDGE is at the Meecham Farm 1931.

TANKTOWN

TROY CORNERS earlier known as Vromans. On Rte 18 between Akron and Medina. Camp Navajo 1937, called Navajo Tourist Camp at Troy Corners 1942.

VALLEY CITY was called Valley City Station. Established as Liverpool Center in 1834.

VALLEY CITY STATION east of the village at the B&O tracks 1921.

WARDS MILL was near Pekin in Hinckley Township

WEAVERVILLE 37 equal lots laid out along north and south sides of Weaverville in the SE corner of Wadsworth Township and 5 houses built on them by 1874.

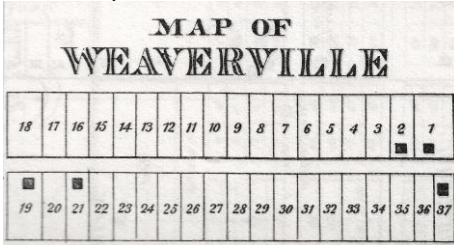

WEYMOUTH Post office established 13 September 1824, closed 13 May 1905.



Weymouth School built 1840.

WEBBERS CORNERS boarded on north by the diagonal road leading to Weymouth and on the east by the highway running to Granger (606 and 94)

WESTERN STAR 97 at South Medina Line Rd on the Medina/Summit County line in Wadsworth. In 1874 and 1897 atlases.

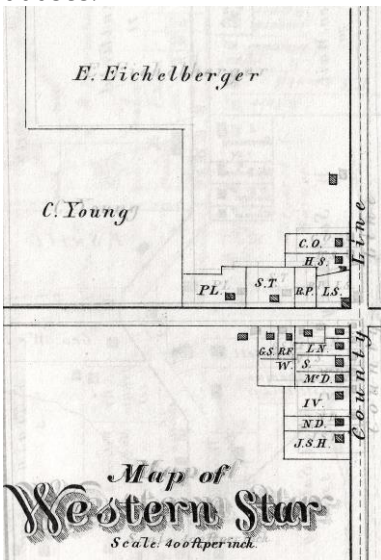

WHITTLESEY Post office 1850, 1880. Known as Lafayette Center by 1897.

WILSON CORNERS David Wilson and his brother John settled a clearing in the northeastern part of Guilford Township in 1816. John Wilson erected the first gristmill in the township gristmill powered by a yoke of oxen on a treadmill. It had a horizontal wheel 15' in diameter. It was a flax mill in 1881.

WINDFALL at rte 18 and Windfall Rd. There is a cemetery and was a school until 1936, the last one-room schoolhouse in Medina County to close. It had a post office from 23 Oct 1883 to 30 Nov 1901.



WINDFALL SCHOOL, 80 years old, is about to be bulldozed out of Windfall and out of the memories of old time Medina residents.

YOUNGS CORNERS In 1915 Wallace Young opened one of first filling stations in Medina County at 18 & 94 near where he lived, "the road junction" became known as Youngs Corners. It was 7 miles east of Medina on Akron Rd in 1931. Traffic light at Youngs Corners taken down 1940, as the county couldn't bear the expense.
